

Asset available for Community Asset Transfer – Flatt Lane Community Centre

Site:50, Flatt Lane, Ellesmere Port, CH65 8DP

Details

Cheshire West and Chester Council welcomes expressions of interest from community, not-for-profit organisations based in Cheshire West, on acquiring via a long-term lease the property known as Flatt Lane Community Centre.



Flatt Lane Community Centre is located on Flatt Lane, Ellesmere Port and next to School Road play area.

Please see this link on the location <https://maps.app.goo.gl/AoR1rdtHSRTra2tV7>

The map shows the location of Flatt Lane Community Centre and surrounding land available for expressions of interest under the community asset transfer process.

The site area is 0.074 ha, (0.18 acres), the building area is 195 m², (2,109 sq. ft) and comprises of rooms formerly used as toilets, commercial kitchen, IT suite and main hall. There is a small courtyard at the entrance and an enclosed grassed area to the rear side of the property and a small car park situated off Flatt Lane.

The building is in a generally poor condition. The asset will be transferred in its current condition.

The building will be open for viewings on:

- Monday 16 June 10-11.00
- Monday 23 June 14-15.00

Please confirm attendance to

ellesmereportlocalities@cheshirewestandchester.gov.uk or call 07799035270 and leave a message.

Last date for Expressions of Interest: Midnight on 25 August 2025

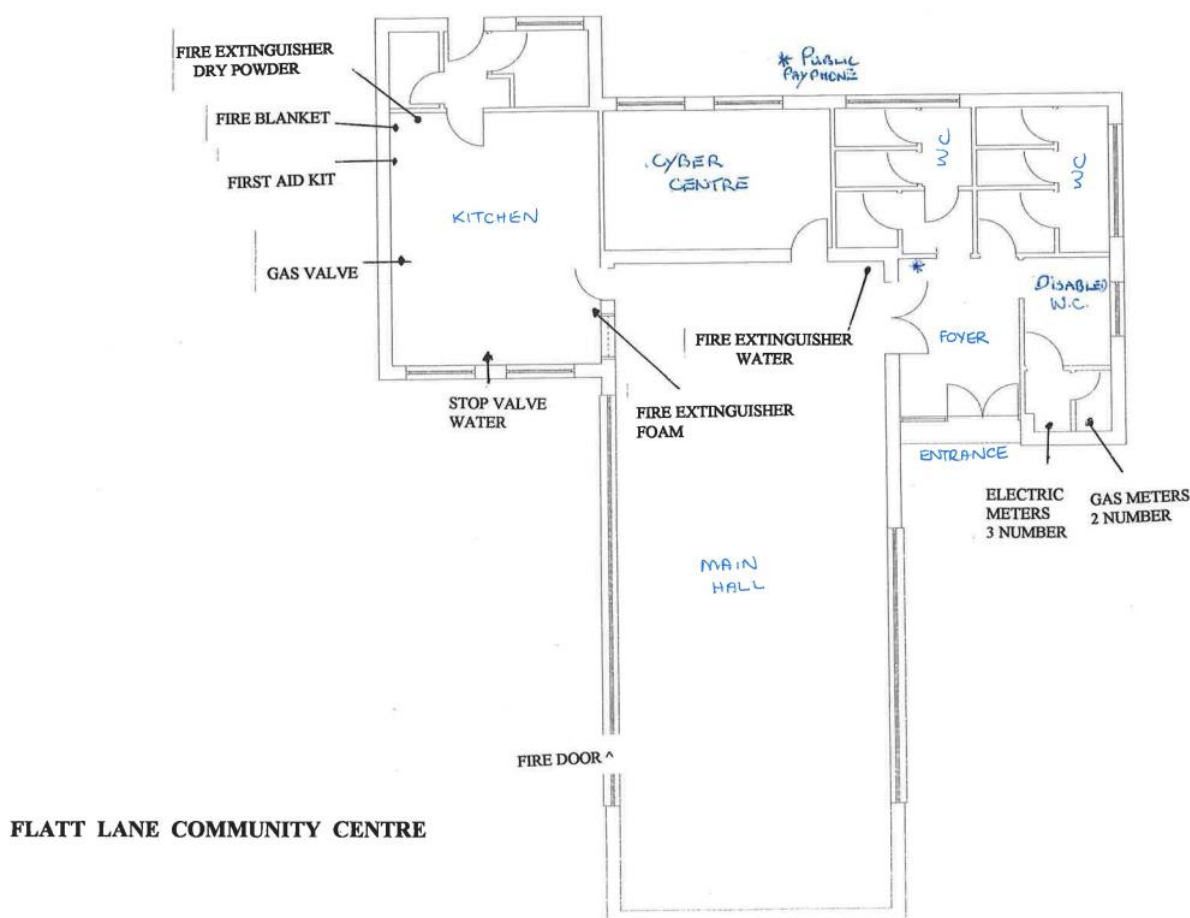

Floor plan not to scale

Community Asset Transfer – Invitation to Submit Expressions of Interest

Introduction

The Council recognises the vital role that community assets play at the heart of their local communities and the invaluable role they have in achieving the Council's corporate outcomes set out in the Borough Plan 2024-2028 [Home | CWC Borough Plan](#). We want to work with you to make this happen.

Cheshire West and Chester Council welcomes Expressions of Interest from community, not-for-profit organisations based locally on acquiring via a long term lease the property known as Flatt Lane Community Centre, 50, Flatt Lane, Ellesmere Port CH65 8DP. Other alternatives to a long-lease may be available to enable an organisation to manage an asset such as a management agreement (up to two years) or short-lease (two to five years).

Process

All Expressions of Interest received will be considered by the Council's Community Asset Transfer Panel.

Eligible applicants will then be invited to submit a Business Case against which an informed decision for transfer will be made. The Business Case is the formal application stage of the process and can only be made by a constituted community group or organisation which delivers a service direct to the community. The Business Case is expected to outline community demand for the service, the governance and capacity of the applicant organisation, the financial viability of the proposal and the extent to which it contributes to delivering the Council's aims and objectives.

The final stage in the process will be the completion and transfer of the asset between the Council and the successful applicant based on the provision of a sustainable business model. The specific terms of the transfer agreement will depend upon the nature of the successful business case and will be negotiated with the successful applicant(s) on completion of this process. Organisations may be invited to work together to deliver services from the premises and we therefore encourage and welcome partnership or consortium-based proposals.

Next Steps

The deadline for submitting your Expression of Interest is midnight on 25 August 2025.

The electronic [Expression of Interest form](#) can be accessed online.

The building will be open for viewings on:

- Monday 16 June 2025: 1000 – 1100
- Monday 23 June 2025: 1400 – 1500

Need Help?

If you have any queries about this document or the Community Asset Transfer process, please contact the Ellesmere Port Communities Team by emailing: ellesmereportlocality@cheshirewestandchester.gov.uk