

# Ellesmere Port Regeneration Update

Latest news from the project team

March 2025



Indicative visualisations of the refurbished market

## Work begins in Ellesmere Port town centre on the biggest investment for decades

**Progress on the £13m government funded town centre regeneration project for Ellesmere Port will increase this month as work progresses on three fronts - the Market, active travel routes and housing site assembly.**

The Town Centre regeneration project is funded by the government, Ministry for Housing, Communities and Local Government through a £13,378,478 allocation.

## Transforming the Market

**As part of the £8m market transformation, temporary stalls will be set up allowing traders to continue to trade whilst part of the market is closed off to allow the works to be carried out safely and to minimise disruption.**

During Phase One of the works, for approximately 60 weeks, the main entrances from the car park and Port Arcades will be closed, however external and internal signage will be in place to direct customers to the remaining entrances and around the temporary layout to find traders' stalls and seating areas. A new Ellesmere Port Market website will provide updates as the works proceed: [www.ellesmereport.market](http://www.ellesmereport.market)

The Council has worked closely with traders to reduce the impact of the works and ensure they can continue to trade. Some stalls will remain where they are and others will be moved to temporary locations, with all traders guaranteed stalls during the works and once the refurbishment is completed in autumn 2026.

Market improvements will include a new building façade, new toilets, seating, improved layout and public wi-fi, plus a new flexible events space will be created in the existing Flea Market area. Externally there will be new solar panels, al fresco area and landscaping along with cycle parking and seating.

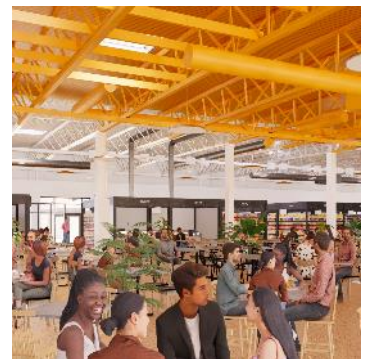

# Ellesmere Port Regeneration Update

Latest news from the project team

March 2025

## Active Travel

**Work on new active travel routes to provide improved walking, wheeling and cycling links will start at the end of March to connect Ellesmere Port railway station into the heart of the town centre, following extensive public consultation held during 2023 and 2024.**



A cycle route will be introduced along Cromwell Road, there will be speed humps and signs with a new 20mph speed limit, a new roundabout will be installed at the junction of Cromwell Road and Wellington Road North to provide a safer environment for cyclists using the road that will allow access to the Market.

A new signalised pedestrian crossing will be added to Whitby Road / Cromwell Road junction, as well as improved side road crossings along Whitby Road. This includes re-aligning kerbs and providing new tactile paving and dropped kerbs at locations that have no facilities. Improvements will also take place along Wellington Road South, with a 20mph speed limit and signage, the installation of a new toucan crossing and a new zebra crossing.



## Civic Way Demolition

**The third element of the project to create sites for new low-carbon housing will take a major step forward with the demolition of the former Council offices in Civic Way.**

This starts in early April and will be a complex process to safely take the building down and clear the site. Prior to works commencing, the contractor will secure the site with fencing and remove all non-structural elements that will be separated to maximise recycling opportunities.

To reduce disturbance, the works on site will only take place from 8am until 6pm on Mondays to Fridays; and from 8am to 1pm on Saturdays with no work permitted on Sundays or bank holidays. The contractor will be expected to ensure disruption, dust and noise is kept to a minimum where possible. The site will also be kept secure throughout the works, which are expected to take six to eight months.

## Market solar panels installed

**As part of the refurbishment works 242 solar panels have now been installed on the market roof.** These will provide the market with over 80,000 kWh of renewable green energy annually, enough to power around 25 homes for a year. The panels will also offset over 18 Tonnes of CO2 each year, and come with a 25-year warranty, so are guaranteed to continue generating renewable energy for many years to come.

