

LOCAL GOVERNMENT AND PUBLIC INVOLVEMENT IN HEALTH ACT 2007

The Cheshire West and Chester Borough Council  
(Reorganisation of Community Governance)  
(Guilden Sutton) Order 2015

Made 30th March 2015  
*Coming into force in accordance with article 1(2)*

Cheshire West and Chester Borough Council ("the Council"), in accordance with section 82 of the Local Government and Public Involvement in Health Act 2007 ("the 2007 Act"), has undertaken a community governance review and made recommendations dated 16th October 2014.

The Council has decided to give effect to those recommendations and, in accordance with section 93 of the 2007 Act, has consulted with the local government electors and other interested persons and has had regard to the need to secure that community governance reflects the identities and interests of the community and is effective and convenient.

The Council, in accordance with section 100 of the 2007 Act, has had regard to guidance issued under that section.

The Council makes the following Order in exercise of the powers conferred by sections 86, 98(3), 98(4) and 240(10) of the 2007 Act.

**Citation and commencement**

1. (1) This Order may be cited as the Cheshire West and Chester Borough Council (Reorganisation of Community Governance) (Guilden Sutton) Order 2015.
- (2) Subject to paragraph (3) below, this Order shall come into force on 1st April 2015.
- (3) For the purposes of:
  - (a) this article, and
  - (b) proceedings preliminary or relating to the election of

parish councillors for the parish of Guilden Sutton, to be held on the ordinary day of election of councillors in 2015, this Order shall come into force on the day after that on which it is made.

### **Interpretation**

2. In this Order—

“borough” means the borough of Cheshire West and Chester;

“existing” means existing on the date this Order is made;

“map” means the map marked “Guilden Sutton Parish Map 2015” and deposited in accordance with section 96(4) of the 2007 Act;

“ordinary day of election of councillors” has the meaning given by section 37 of the Representation of the People Act 1983; and

“registration officer” means an officer appointed for the purpose of, and in accordance with, section 8 of the Representation of the People Act 1983.

### **Effect of Order**

3. This Order has effect subject to any agreement under section 99 (agreements about incidental matters) of the Local Government and Public Involvement in Health Act 2007 relevant to any provision of this Order.

### **Area affected by the Order**

4. The area affected by this Order is shown on the map.

### **Alteration of parish areas**

5. (1) Each area marked and designated by a letter on the map and more particularly delineated on the corresponding inset map and specified in column (1) of Schedule 1 shall cease to be part of the existing parish specified in relation to that area in column (2) of Schedule 1 and shall become part of the parish specified in relation to that area in column (3) of Schedule 1.

(2) In consequence of paragraph (1) the altered area of the parish of Guilden Sutton shall comprise the area edged red on the map.

**Electoral register**

6. The registration officer for the borough shall make such rearrangement of, or adaptation of, the register of local government electors as may be necessary for the purposes of, and in consequence of, this Order.

**Transfer of property, rights and liabilities**

7. The land, property, rights and liabilities described in Schedule 2 shall transfer from the Parish Council of Great Boughton to the Parish Council of Guilden Sutton on the date specified in column (2) of Schedule 2.

**Order date**

8. 1st April 2015 is the order date for the purposes of the Local Government (Parishes and Parish Councils) (England) Regulations 2008.

The **COMMON SEAL** of  
**CHESHIRE WEST AND CHESTER**  
**BOROUGH COUNCIL** was hereunto affixed  
In the presence of

*Kathryn A Brodie*

Authorised Signatory

Dated *30th March 2015*



## SCHEDULE 1

### ALTERATION OF AREAS OF PARISHES

<i>Column (1)</i>	<i>Column (2)</i>	<i>Column (3)</i>
<i>Area</i>	<i>Existing parish from which omitted</i>	<i>Parish to which added from 1st April 2015</i>
A	Hoole Village	Guilden Sutton
B	Mickle Trafford	Guilden Sutton
C	Littleton	Guilden Sutton
D	Great Boughton	Guilden Sutton

## SCHEDULE 2

### LAND AND PROPERTY TO BE TRANSFERRED FROM THE PARISH COUNCIL OF GREAT BOUGHTON

<i>Column (1)</i>	<i>Column (2)</i>
<i>Land and property to be transferred</i>	<i>Date</i>
Beacon and Roadside Barrier	1st April 2015
Noticeboard	1st April 2015

### EXPLANATORY NOTE

*(This note is not part of the Order)*

Cheshire West and Chester Borough Council has undertaken community governance reviews of 161 existing parishes within the borough of Cheshire West and Chester and has made recommendations for the reorganisation of community governance to come into effect from 1st April 2015.

This Order gives effect to recommendations made by Cheshire West and Chester Borough Council in the community governance review for the parish of Guilden Sutton.

The parish of Guilden Sutton will be altered with effect from 1st April 2015.

Article 6 obliges the Electoral Registration Officer to make any necessary amendments to the electoral register to reflect the new electoral arrangements.

The map defined in article 2 shows the altered boundary for the parish of Guilden Sutton. It is available, together with the inset maps, at all reasonable times at the offices of Cheshire West and Chester Borough Council.



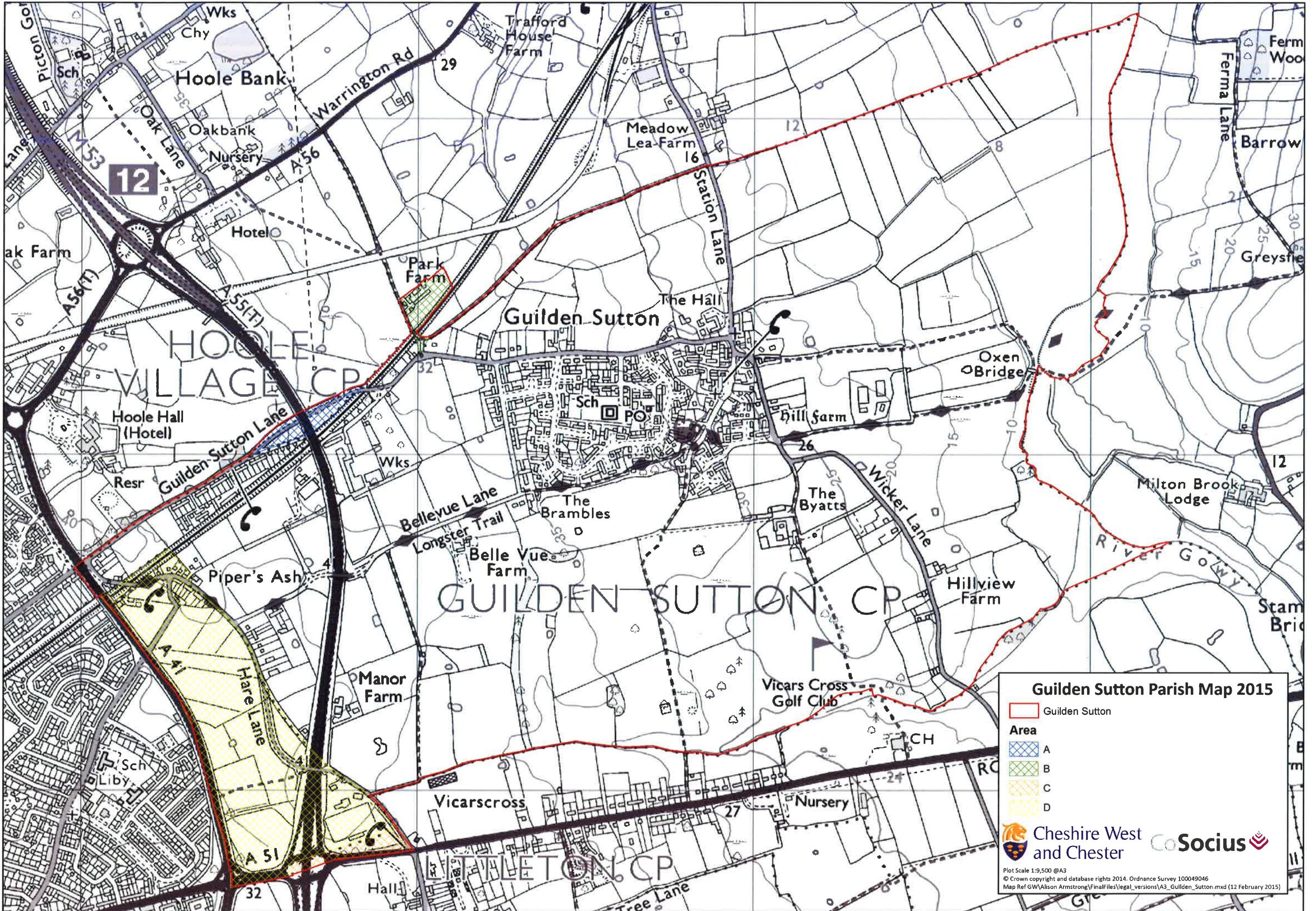

**Guilden Sutton Parish Map 2015**

Guilden Sutton

**Area**

- A
- B
- C
- D

Cheshire West and Chester
 Socius

Plot Scale 1:9,500 @A3  
 © Crown copyright and database rights 2014. Ordnance Survey 100049046  
 Map Ref GW\Alison Armstrong\FinalFiles\legal\_versions\A3\_Guilden\_Sutton.mxd (12 February 2015)



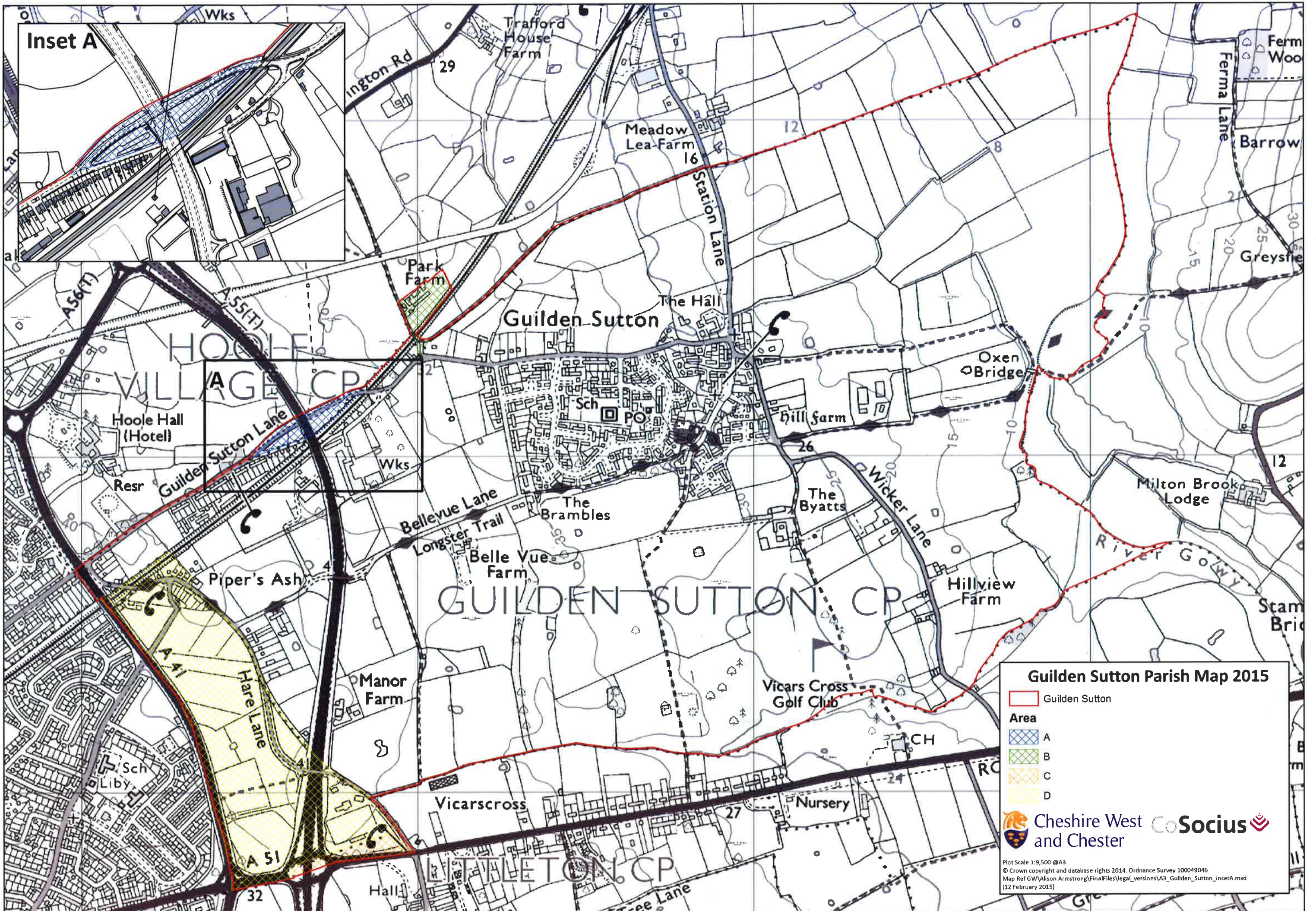

**Inset A**

**Guilden Sutton Parish Map 2015**

Guilden Sutton  
**Area**  
 A  
 B  
 C  
 D

Cheshire West and Chester
 Socius

Plot Scale 1:9,500 @A3  
 © Crown copyright and database rights 2014. Ordnance Survey 100049046  
 Map Ref GW\Alison Armstrong\FinalFiles\legal\_versions\A3\_Guilden\_Sutton\_insetA.mxd  
 (12 February 2015)



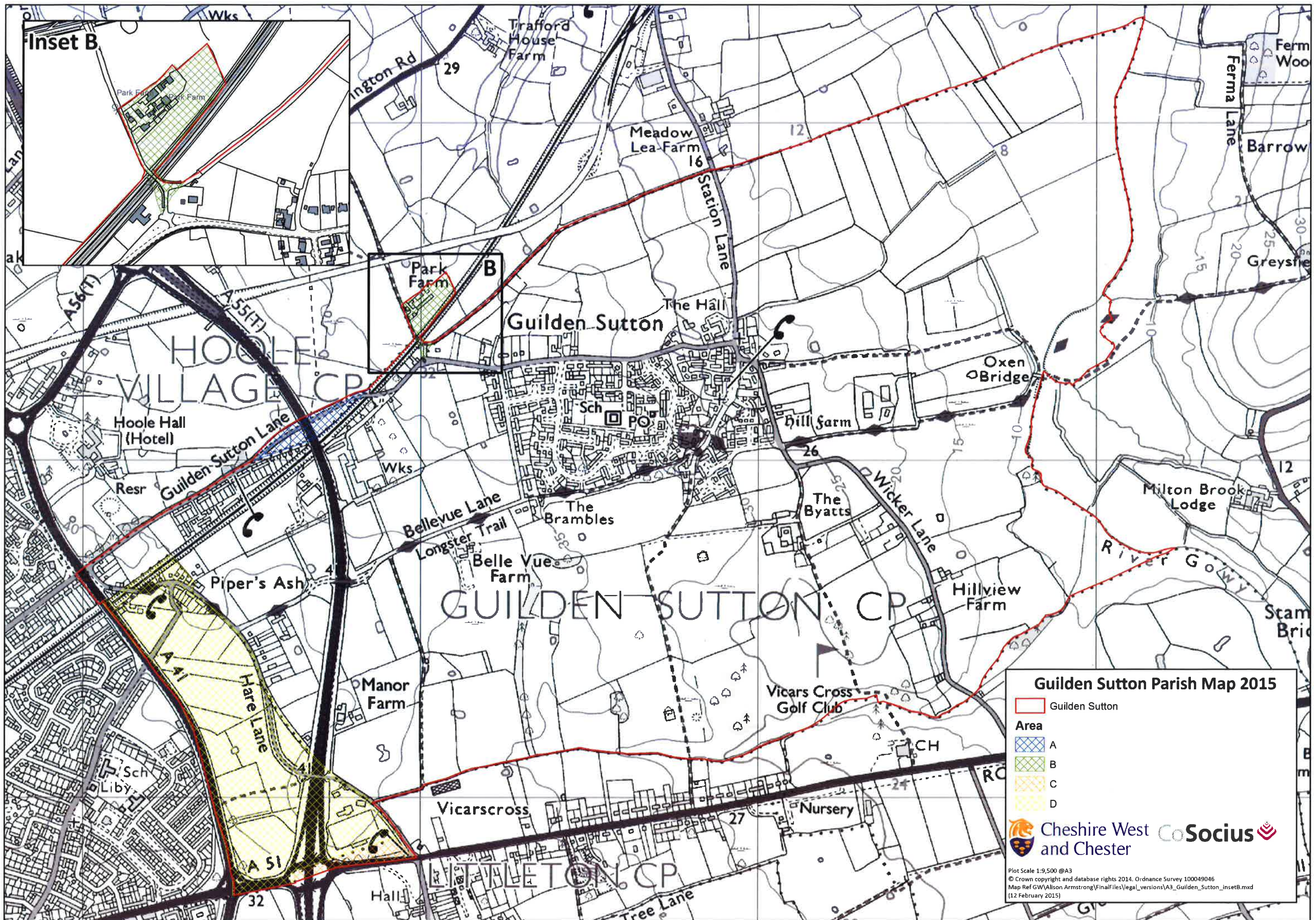

**Inset B**

**Guilden Sutton**

**GUILDEN SUTTON CP**

**Guilden Sutton Parish Map 2015**

- Guilden Sutton
- Area**
- A
- B
- C
- D

**Cheshire West and Chester** **CoSocius**

Plot Scale 1:9,500 @A3  
 © Crown copyright and database rights 2014. Ordnance Survey 100049046  
 Map Ref GW\Allison Armstrong\FinalFiles\legal\_versions\A3\_Guilden\_Sutton\_insetB.mxd  
 (12 February 2015)



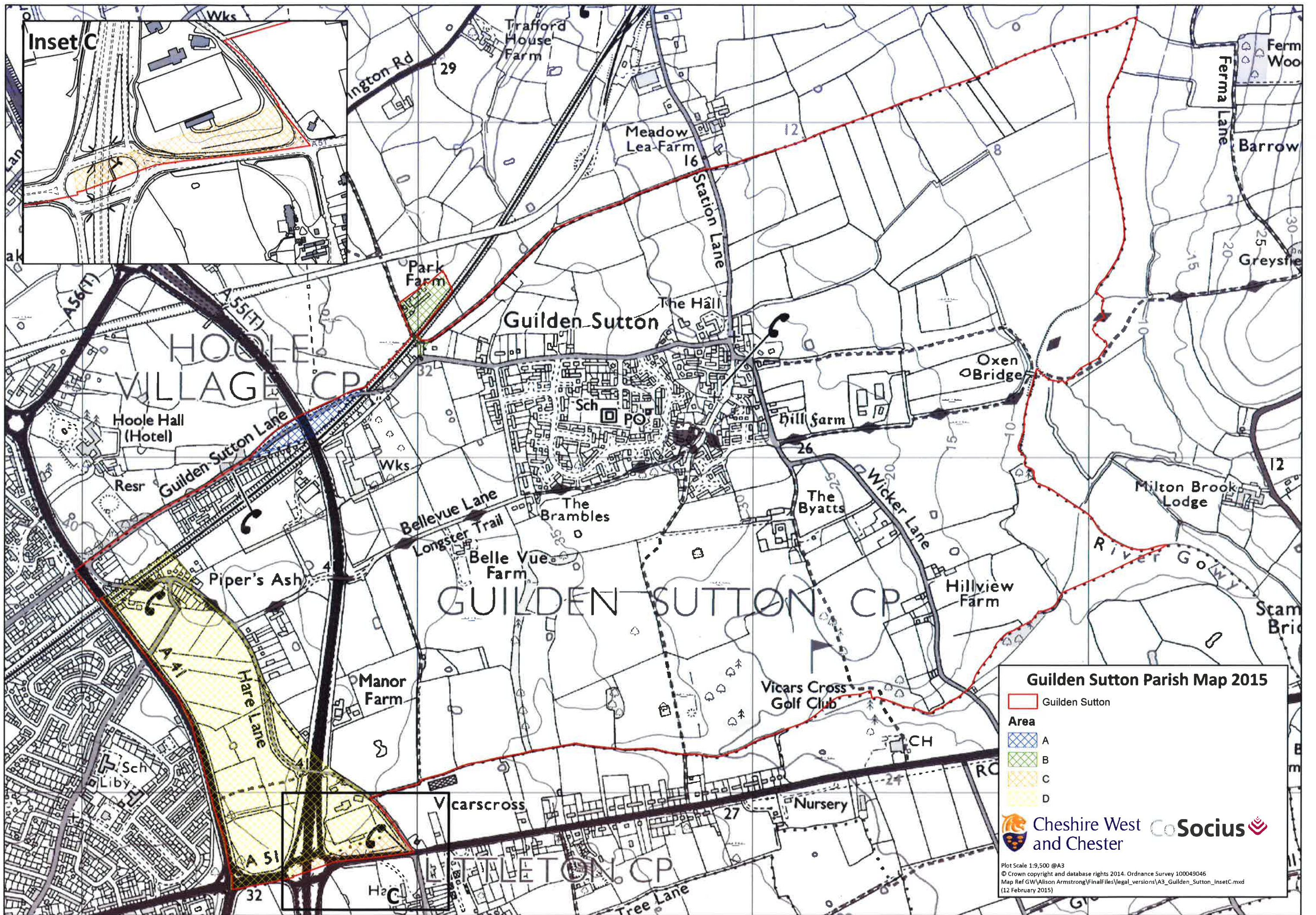

**Inset C**

**Guilden Sutton Parish Map 2015**

- Guilden Sutton
- Area**
- A
- B
- C
- D

Cheshire West and Chester **CoSocius**

Plot Scale 1:9,500 @A3  
 © Crown copyright and database rights 2014. Ordnance Survey 100049046  
 Map Ref GW\Alison Armstrong\FinalFiles\legal\_versions\A3\_Guilden\_Sutton\_InsetC.mxd  
 (12 February 2015)



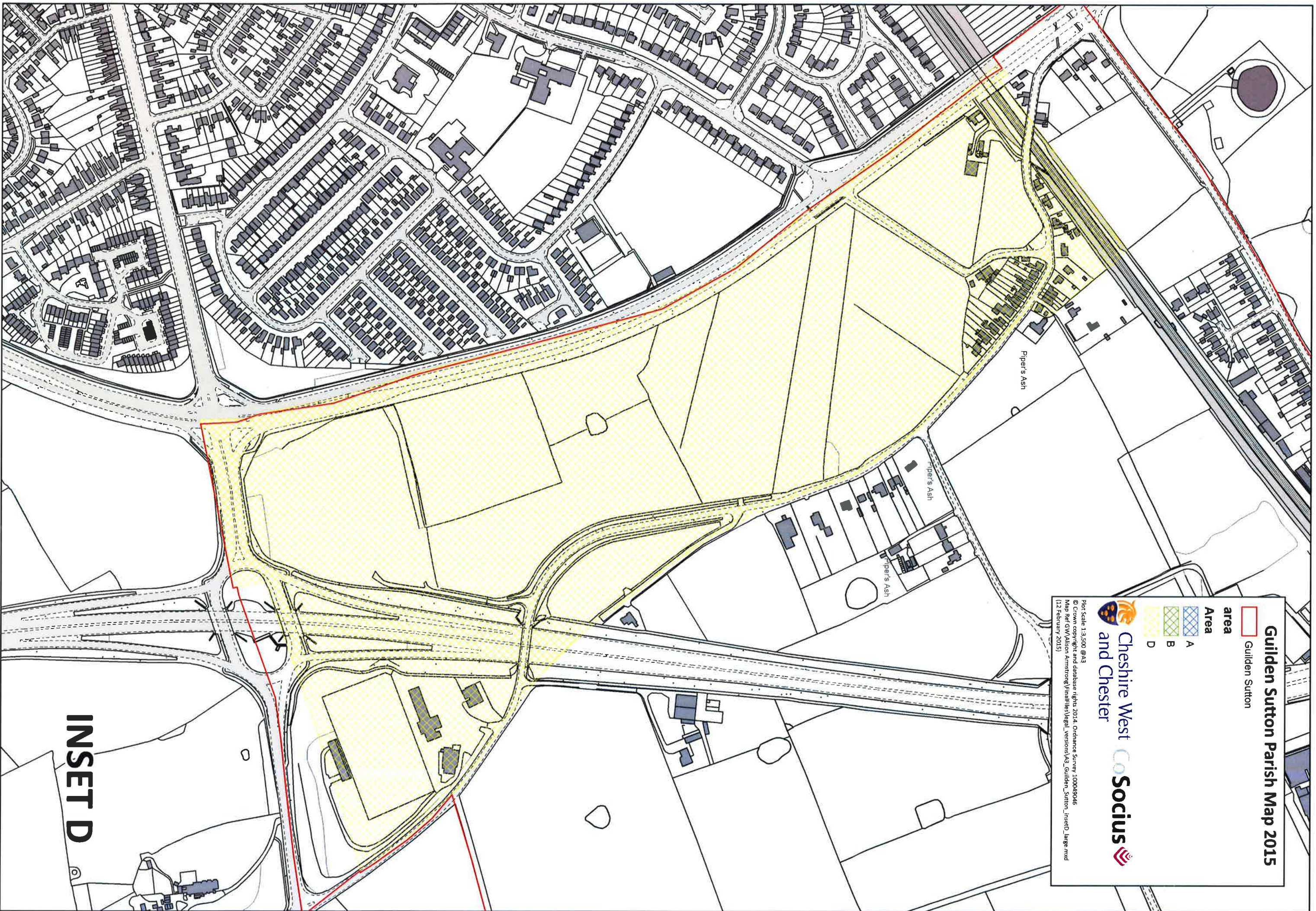

**Guilden Sutton Parish Map 2015**

area  Guilden Sutton

Area

A 

B 

D 

 **Socius**  
 Cheshire West  
 and Chester

Plot Scale 1:3,500 @A3  
 © Crown copyright and database rights 2014, Ordnance Survey 100049046  
 Map Ref G:\M\Alison\_Armstrong\Final\legal\_versions\A3\_Guilden\_Sutton\_InsetD\_Large.mxd  
 (12 February 2015)