

LOCAL GOVERNMENT AND PUBLIC INVOLVEMENT IN HEALTH ACT 2007

The Cheshire West and Chester Borough Council
(Reorganisation of Community Governance)
(Rudheath) Order 2015

Made

30th March

2015

Coming into force in accordance with article 1(2)

Cheshire West and Chester Borough Council ("the Council"), in accordance with section 82 of the Local Government and Public Involvement in Health Act 2007 ("the 2007 Act"), has undertaken a community governance review and made recommendations dated 16th October 2014.

The Council has decided to give effect to those recommendations and, in accordance with section 93 of the 2007 Act, has consulted with the local government electors and other interested persons and has had regard to the need to secure that community governance reflects the identities and interests of the community and is effective and convenient.

The Council, in accordance with section 100 of the 2007 Act, has had regard to guidance issued under that section.

The Council makes the following Order in exercise of the powers conferred by sections 86, 98(3), 98(4) and 240(10) of the 2007 Act.

Citation and commencement

1. (1) This Order may be cited as the Cheshire West and Chester Borough Council (Reorganisation of Community Governance) (Rudheath) Order 2015.
- (2) Subject to paragraph (3) below, this Order shall come into force on 1st April 2015.
- (3) For the purposes of:
 - (a) this article, and
 - (b) proceedings preliminary or relating to the election of

parish councillors for the parish of Rudheath, to be held on the ordinary day of election of councillors in 2015, this Order shall come into force on the day after that on which it is made.

Interpretation

2. In this Order—

“borough” means the borough of Cheshire West and Chester;

“map” means the map marked “Rudheath Parish Map 2015” and deposited in accordance with section 96(4) of the 2007 Act;

“ordinary day of election of councillors” has the meaning given by section 37 of the Representation of the People Act 1983; and

“registration officer” means an officer appointed for the purpose of, and in accordance with, section 8 of the Representation of the People Act 1983.

Effect of Order

3. This Order has effect subject to any agreement under section 99 (agreements about incidental matters) of the Local Government and Public Involvement in Health Act 2007 relevant to any provision of this Order.

Area affected by the Order

4. The area affected by this Order is shown on the map.

Alteration of parish areas

5. (1) Each area marked and designated by a letter on the map and more particularly delineated on the corresponding inset map and specified in column (1) of Schedule 1 shall cease to be part of the parish specified in relation to that area in column (2) of Schedule 1 and shall become part of the parish specified in relation to that area in column (3) of Schedule 1.

(2) In consequence of paragraph (1) the altered area of the parish of Rudheath shall comprise the area edged red on the map.

Electoral register

6. The registration officer for the borough shall make such rearrangement of, or adaptation of, the register of local government electors as may be necessary for the purposes of, and in consequence of, this Order.

Order date

7. 1st April 2015 is the order date for the purposes of the Local Government (Parishes and Parish Councils) (England) Regulations 2008.

The **COMMON SEAL** of
CHESHIRE WEST AND CHESTER
BOROUGH COUNCIL was hereunto affixed
In the presence of

Kathryn Brodu

Authorised Signatory

Dated 30th March 2015



SCHEDULE 1

ALTERATION OF PARISH AREAS

<i>Column (1)</i>	<i>Column (2)</i>	<i>Column (3)</i>
<i>Area</i>	<i>Parish from which omitted</i>	<i>Parish to which added from 1st April 2015</i>
A	Northwich	Rudheath
B	Rudheath	Davenham

EXPLANATORY NOTE

(This note is not part of the Order)

Cheshire West and Chester Borough Council has undertaken community governance reviews of 161 existing parishes within the borough of Cheshire West and Chester and has made recommendations for the reorganisation of community governance to come into effect from 1st April 2015.

This Order gives effect to recommendations made by Cheshire West and Chester Borough Council in the community governance review for the parish of Rudheath.

The parish of Rudheath will be altered with effect from 1st April 2015.

Article 6 obliges the Electoral Registration Officer to make any necessary amendments to the electoral register to reflect the new electoral arrangements.

The map defined in article 2 shows the altered boundary for the parish of Rudheath. It is available, together with the inset maps, at all reasonable times at the offices of Cheshire West and Chester Borough Council.

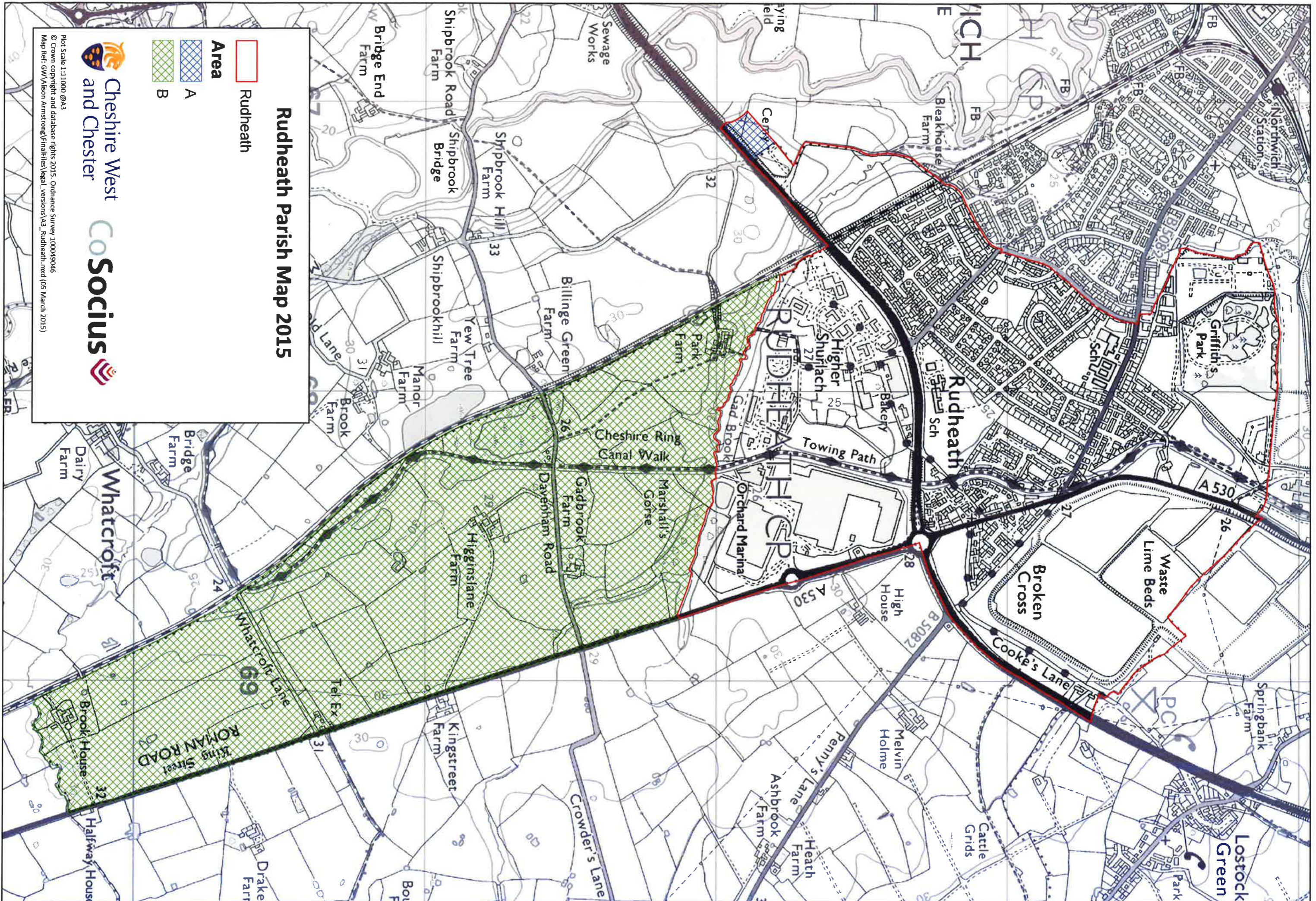

Rudheath Parish Map 2015

Rudheath

Area

A

B



Cheshire West
and Chester



Plot Scale 1:1000 @A3
© Crown copyright and database rights 2015. Ordnance Survey 100049046
Map Ref: GWA\Aison Armstrong\Final\files\legal_versions\A3_Rudheath.mxd (05 March 2015)

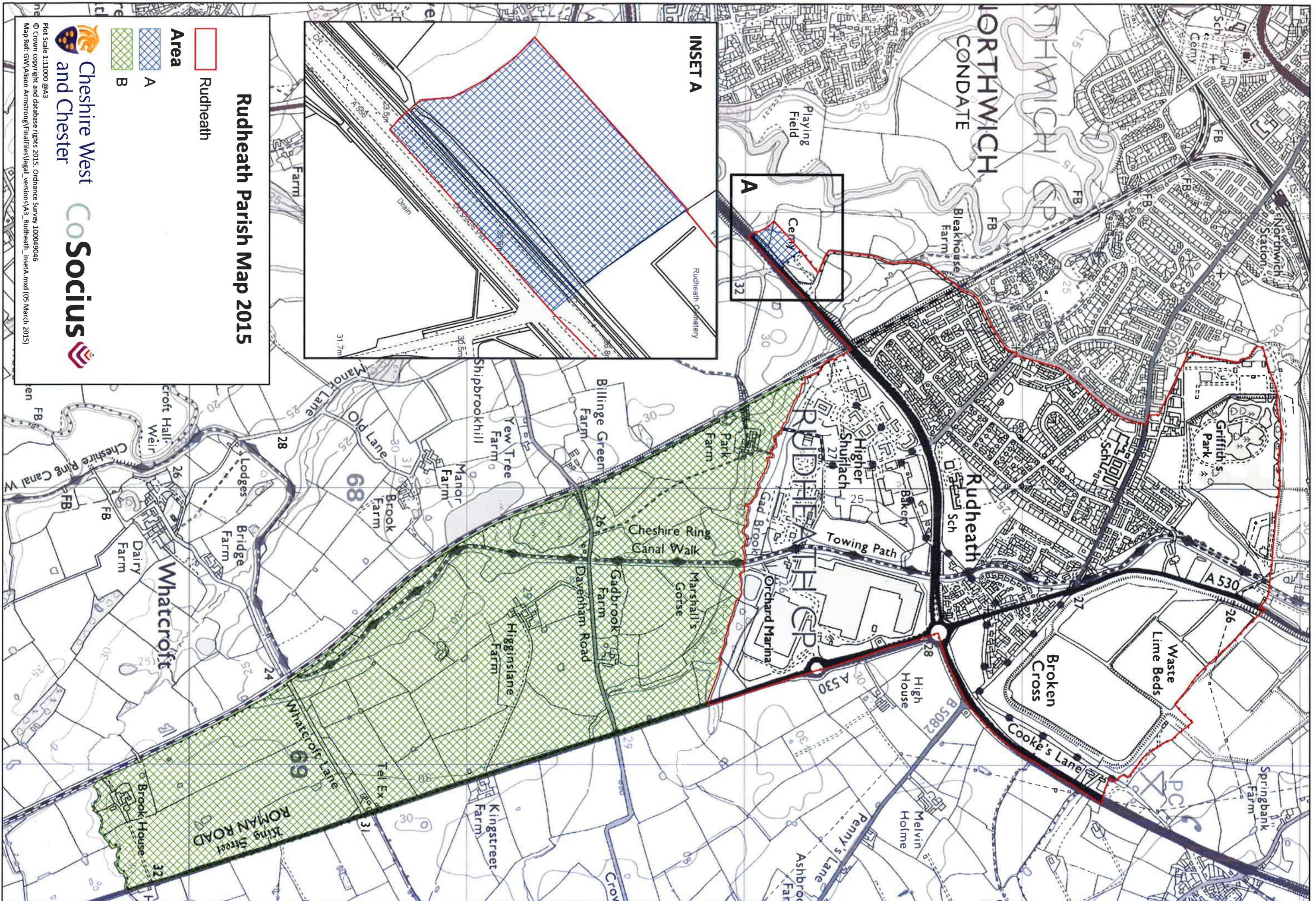

Rudheath Parish Map 2015

- Rudheath
- Area**
- A
- B

Cheshire West and Chester **Socius**

Plot Scale 1:11000 @A3
 © Crown copyright and database rights 2015. Ordnance Survey 100049046
 Map Ref: GW\A\son Armstrong\FinalFiles\legal_versions\A3_Rudheath_insetA.mxd (05 March 2015)

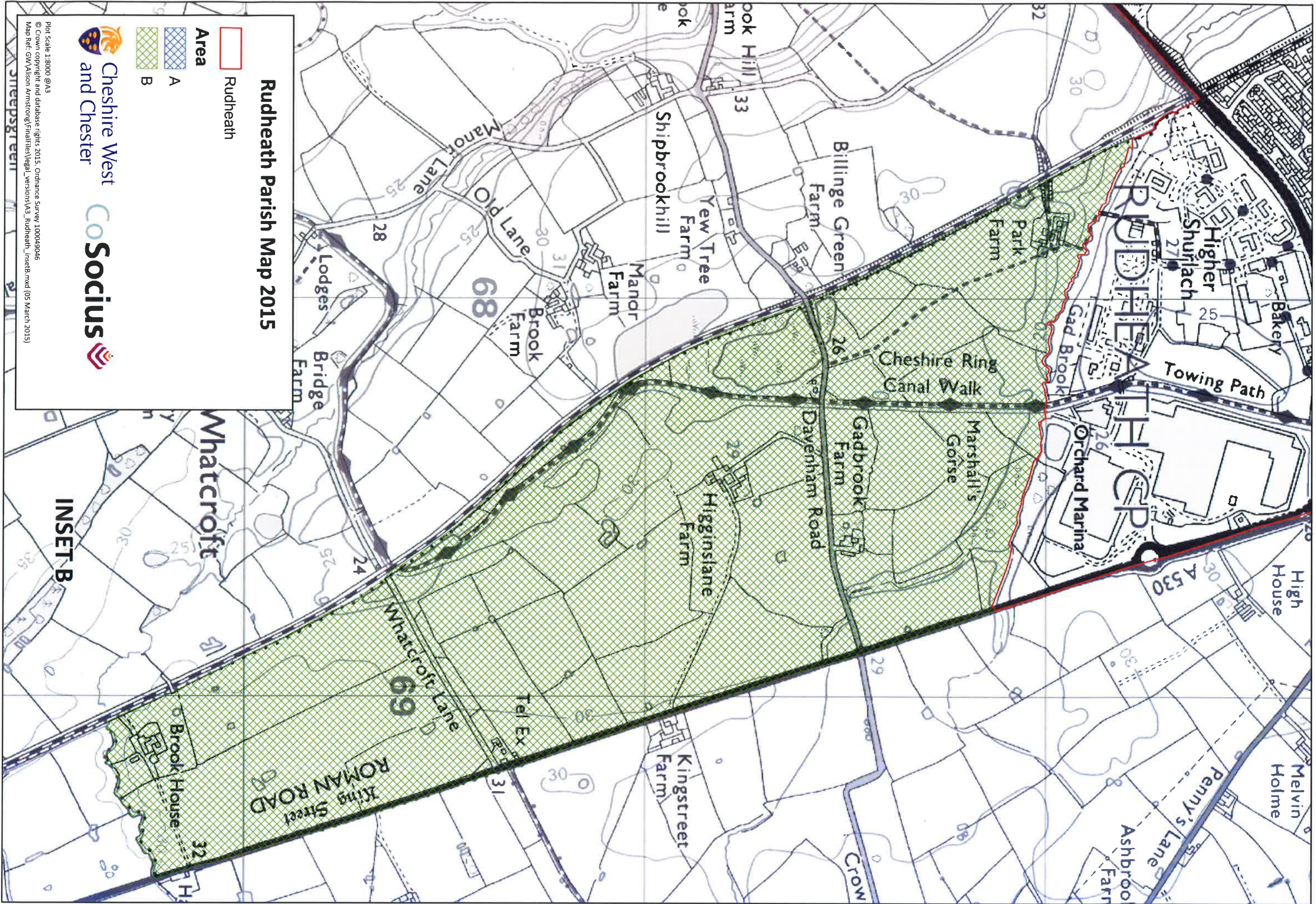

Rudheath Parish Map 2015

 Rudheath

Area

 A

 B

 Cheshire West
and Chester

 Socius

Plot Scale 1:8000 @A3
 © Crown copyright and database rights 2015. Ordnance Survey 100049046
 Map Ref: G:\M\A\son Armstrong\FinalFiles\legal_versions\A3_Rudheath_insetB.mxd (05 March 2015)

INSET B

Whatcroft

ROMAN ROAD

RUDHEATH